

P-tec Corp. Tel:(866) 695 4162
 2405 Commerce Circle Tel:(719) 589 3122
 Alamosa CO 81101 Fax:(719) 589 3592
 www.p-tec.net



PD07 Series Single Digit 7 Segment 0.39" Display

Features

- *Single Digit .39" (10.0mm) Super Bright Red Display with 10 Pins
- *Low Current Requirements
- *High Light Output
- *IC Compatible
- *High Reliability
- *Gray Face, White Segments
- *RoHS Compliant

Absolute Maximum Ratings at $T_A = 25^\circ\text{C}$

Power Dissipation.....	66mW
Reverse Voltage (<100 μ A).....	4.0V
Max Forward Current.....	30mA
Peak Forward Current (1/10 Duty Cycle, 0.1ms Pulse Width).....	100mA
Operating Temperature Range.....	-25°C to +85°C
Storage Temperature Range.....	-40°C to +100°C
Soldering Temperature (1.6 mm below body).....	260°C for 5 seconds

Electrical & Optical Characteristics at $T_A = 25^\circ\text{C}$

Part Number		Emitting Color	Chip Material	Peak Wave Length	Dominant Wave Length	Forward Voltage @20mA (V)		Luminous Intensity @10mA (mcd)	
						Typ	Max	Min	Typ
Common Anode	Common Cathode			nm	nm				
PD07-CADR21	PD07-CCDR21	Deep Red	AlGaAs	660	643	1.8	2.2	6.0	12.0

All dimensions are in **Millimeters**. Tolerance is $\pm 0.25\text{mm}$ unless otherwise specified. The Slope Angle of any Pin may be $\pm 5^\circ$ max.

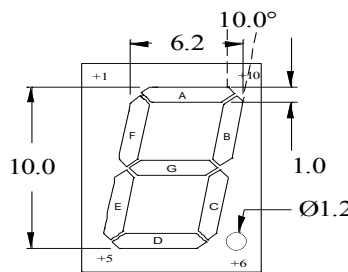
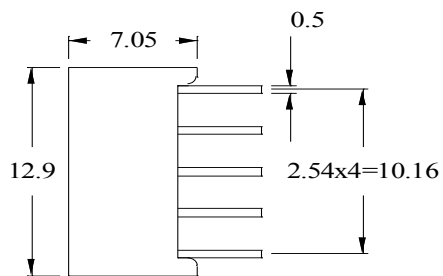
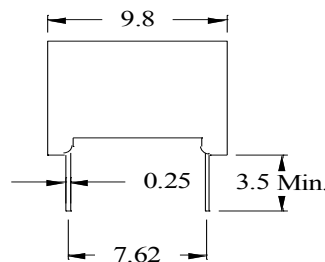

Pin Function	
Common Anode Pin #	Common Cathode Pin #
1 Cathode G	1 Anode G
2 Cathode F	2 Anode F
3 Common Anode	3 Common Cathode
4 Cathode E	4 Anode E
5 Cathode D	5 Anode D
6 Cathode DP	6 Anode DP
7 Cathode C	7 Anode C
8 Common Anode	8 Common Cathode
9 Cathode B	9 Anode B
10 Cathode A	10 Anode A