



PL00182 Series Bi-Color SMD LED 1210 Package

Features

- *Flat lens thin package 3.2 x 2.7 x 1.1mm
- *Low current requirements
- *High light output
- *Compatible with IR solder-process
- *Industry standard footprint
- *4000 pcs per reel
- *RoHS compliant

Absolute Maximum Ratings at T_A = 25°C

Power Dissipation.....	69mW (R), 65mW (G)
Reverse Voltage (<10μA)	5.0V
Max Forward Current	30mA
Peak Forward Current(1/10 Duty Cycle, 0.1ms Pulse Width).....	100mA
Operating Temperature Range	-40°C to +85°C
Storage Temperature Range	-40°C to +85°C
Reflow Soldering Temperature.....	260°C for 10 seconds

Electrical & Optical Characteristics at T_A = 25°C

Part Number	Emitting Color	Chip Material	Dominant Wave Length (nm) Typ	Peak Wave Length (nm) Typ	Viewing Angle 2θ1/2 Deg	Forward Voltage @20mA (V)		Luminous Intensity @20mA (mcd)	
						Typ	Max	Min	Typ
PL00182-WCGY1322	Green	GaP	573	575	120°	2.0	2.6	7.2	18
	Yellow	GaAsP	590	592		2.1	2.6	3.6	11.5

Package Dimensions are in **Millimeters**. Tolerance is ± 0.15mm unless otherwise specified.

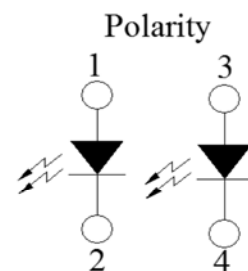
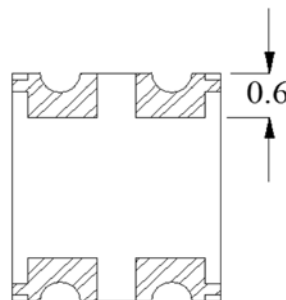
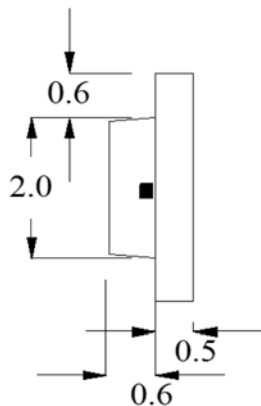
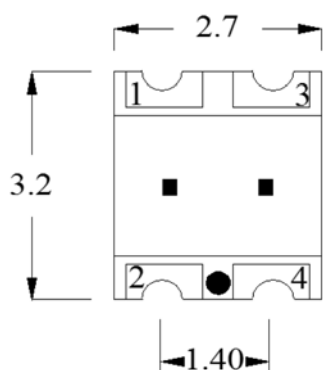

Recommended Soldering Pad Layout

